

 **kit**
bluetooth
internet radio
car kit



User Guide

LVC02A

Livio  **Radio**

Version 1.1



Made for



iPod



iPhone

MADE FOR

- iPod touch® (2nd, 3rd, and 4th generation)
- iPhone® 4
- iPhone 3G
- iPhone 3GS

“Made for iPod,” and “Made for iPhone,” mean that an electronic accessory has been designed to connect specifically to iPod, or iPhone, respectively, and has been certified by the developer to meet Apple performance standards. Apple is not responsible for the operation of this device or its compliance with safety and regulatory standards. Please note that the use of this accessory with iPod, or iPhone, may affect wireless performance.

iPhone, iPod touch and iTunes are trademarks of Apple, Inc., registered in the U.S. and other countries.

CONTENTS

INTRODUCTION	3
QUICK START	4
WHAT'S WHAT DIAGRAM	6
USING THE LIVIO CAR INTERNET RADIO APP	9
PHONE OPERATIONS	12
BLUETOOTH OPERATIONS	12
FREQUENTLY ASKED QUESTIONS	13
SPECIFICATIONS	16
IMPORTANT SAFETY INSTRUCTIONS	17
WARRANTY	17



Thank you for purchasing your new Bluetooth Internet Radio Car Kit. You now have access to Internet radio, hands-free calling, music streaming and remote control capabilities for any music application on your Smartphone.

In addition, the Bluetooth Internet Radio Car Kit comes with the premium version of Livio Car Internet Radio application that gives you access to more than 45,000 AM/FM and Internet-only radio stations from around the world for seamless and safe integration into the vehicle without monthly fees.

The Kit also has a built-in USB charger to charge your phone or any other USB device, an AUX input to connect your MP3 player and an AUX output to connect to your factory stereo (if available in your vehicle).

Feel free to call us with questions, comments or suggestions:

1-877-97-LIVIO

Or send an e-mail with your comments or suggestions to:

help@livioreadio.com

You can also visit us on the web, where you'll find plenty of instructional videos and product support:

www.livioreadio.com/help

Happy listening!

INTRODUCTION

ABOUT LIVIO

We love radio. Really, it's the driving force behind our work. Like our products themselves, we're a hip and laid-back bunch. No frills. No crazy features. No cumbersome junk. We do our jobs so you don't have to, and we find ways to bring online audio to more people, in more places.

Thank you for your purchase and enjoy!

ABOUT RADIOTIME

RadioTime is the leading radio tuner that powers Internet services and devices by connecting them to radio broadcast DJs, talk personalities, and sports programming. Listeners easily access free, live, local, and global radio programming through RadioTime service. Its service enhances other products and services by powering them with thousands of radio channels and programming. RadioTime, founded in 2002, is based in Dallas, Texas. More information is available at www.radiotime.com.

TECHNOLOGIES INSIDE

1. **Bluetooth Hands-Free (HFP):** Wirelessly connects to your mobile phone for hands-free calling.
2. **Bluetooth Stereo Audio Receiver (A2DP):** Wirelessly connects to your mobile phone for easy music streaming.
3. **FM Transmitter (FM-RDS Transmit):** Wirelessly transmits audio and data (artist/title/station) information to any FM radio that can receive RDS.
4. **Line Input (AUX Input):** Receives a stereo audio signal from any connected audio player (MP3, CD, etc).
5. **Line Output (AUX Output):** Sends a variable stereo audio output to any car stereo equipped with a 1/8" (3.5 mm) stereo auxiliary (AUX) input. Use with the included 3.5mm AUX cable.
6. **USB Charging:** Provides 5V 1A charge that will charge most USB chargeable devices like phones and other electronic devices.

QUICK START

BEFORE CONNECTING, PLEASE READ THE ENTIRE SAFETY SECTION OF THIS USER GUIDE.



FASTEST WAY TO GET THE KIT UP AND RUNNING:

1. Connect and power up
 - a. Connect the Kit to your car's 12V adapter and press the power switch on the end of the power adapter to turn it on.
 - b. If the Kit has never been paired to a device before, the Kit will be flashing red and green indicating it is ready to connect (pair) with your mobile phone. Proceed to Step 2 for Bluetooth setup.
 - c. If the Kit has previously been paired to a device, press the red END CALL button on the Kit and hold for approximately 3 seconds. The Kit will flash green and red indicating it is ready to connect (pair) with your mobile phone.
2. Setting up Bluetooth on your phone (Bluetooth Pairing)
 - a. Apple product users:

From the home screen on your Apple product, select:
Settings -> General -> Bluetooth -> livio_lvc02a.
3. Install the Livio Car Internet Radio app on your phone.
 - a. Apple product users:

If the app is not already installed on your device, it will automatically prompt you to download it when Bluetooth pairing is complete. If you have already downloaded the app, press the LAUNCH button on the Kit (three dots) to start the app.

When connected to the Kit, the Kit will temporarily unlock the Livio app, giving you access to more than 45,000 stations. When your phone is NOT connected to the Kit, the app will not be able to access the full station list unless you have paid for the upgrade. All stored presets and favorites will still be available on your device, however, even if you have not paid for the upgrade.

4. Sending music to your car
 - a. Turn the knob on the Kit to select an unused FM frequency or press and hold the knob for 2-3 seconds to automatically scan to an unused FM frequency.
 - b. Tune your FM stereo into the same frequency shown on the Kit.
 - c. To adjust the master output volume of the Kit, press the knob (FM frequency will change to the volume) and adjust the volume output from 0-15.

NOTE: TO SWITCH TO EUROPEAN FM MODES (EVEN NUMBER STATIONS) PRESS AND HOLD THE KNOB FOR FIVE SECONDS. THE SCREEN WILL THEN DISPLAY "US" AND "EU." ROTATE THE KNOB TO SELECT THE DESIRED FM FREQUENCY TYPE. THE US MODE INCLUDES ODD NUMBERS (.1, .3, .5, ETC.). THE EU MODE INCLUDES ALL NUMBERS. (.1, .2, .3, ETC).

That's it! You're ready to rock! Always drive safely and avoid distractions.

WHAT'S WHAT DIAGRAM

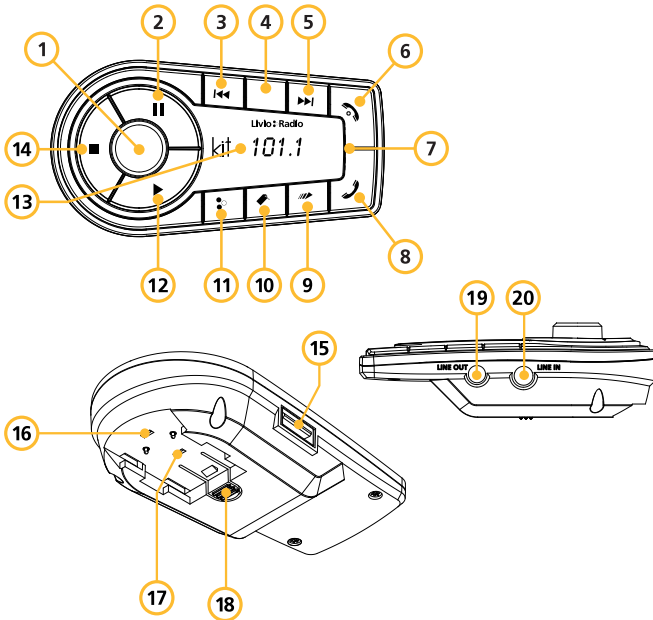

1. **Knob:** Controls volume, manual station entry, scan and switching between US and EU modulation.
2. **Pause:** Press to temporarily stop the audio. Press Play button to resume audio.
3. **Previous or Rewind:** Skip backwards through stations in the Presets and Favorites Menu.
4. **Blank:** Not used at this time.
5. **Next or Fast-forward:** Skip forward through stations on the Presets and Favorites Menu.
6. **End Call:** End call button.
7. **Microphone:** This is where the hidden noise-canceling microphone is located for voice activation and phone calls.
8. **Start Call Button:** Press to activate the voice dialing function on your phone. Double-press to activate the re-dial function. When a call is coming in to your phone, press to answer the call.
9. **Scan (Livio app only):** Press to find a station similar to the one currently playing.
10. **Tag (Livio app only):** Put the name and artist of the song

currently playing in the Tag Menu list to e-mail, share with friends or purchase directly from iTunes®.

- 11. Launch Livio App:** Press to launch Livio Car Internet Radio app. Note that the auto launch command only works from the home screen (as permitted by Apple iOS). Press and hold for 3 seconds to toggle the auto launch when the Kit is powered on.
- 12. Play Button:** Sends the play command to your device to play music.
- 13. LED Display:** Displays the FM station being used for transmission or volume of the Kit.
- 14. Stop Button:** Sends the stop command to your device to stop music.
- 15. USB Charging Port:** Charge your phone or other USB-powered devices by connecting them through this port.
- 16. Charging/Software Update Switch:** To enable charging by the Kit, the lightning bolt must be selected.
- 17. A/B Software Select Switch:** For the Kit to work with an Apple product, the switch must be positioned on side 'B.' Side 'A' is not used at this time.
- 18. Gooseneck Release Button:** Press and slide down to remove the Kit from gooseneck as shown on the diagram. When reattaching the Kit to the gooseneck, be careful not to break the gold power pins. If you are forcing it, please check the diagram again. The Kit will not work if it is not connected to the gooseneck.



- 19. Line Output (AUX Output):** Sends a variable stereo audio output to any car stereo equipped with a 1/8" (3.5mm) stereo auxiliary (AUX) input. Connect to your stereo with the included AUX cable.
- 20. Line Input (AUX Input):** Receives a stereo audio signal from any connected audio player (MP3, CD, etc).
- 21. Base of Gooseneck:** Secures the Kit.

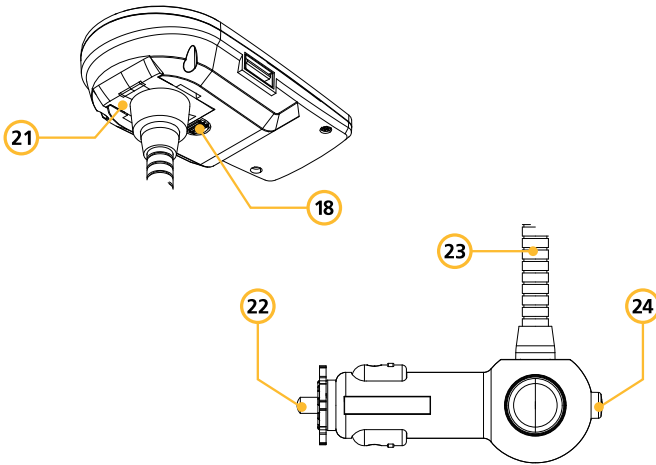

22. **Fuse Removal:** To replace fuse, unscrew the end counter clockwise and remove fuse. Fuse type is on the last page of this user guide.
23. **Gooseneck:** Allows for flexible viewing angles.
24. **Power Button:** When you turn off your vehicle, if the 12V power supply does not shut off automatically, you will need to turn off the power switch on the Kit manually. Most vehicles will shut off the power supply on their own but the car battery may drain if you leave the Kit on while the vehicle is shut off. You can easily tell if there is power by the blue power on light on the base of the Kit.

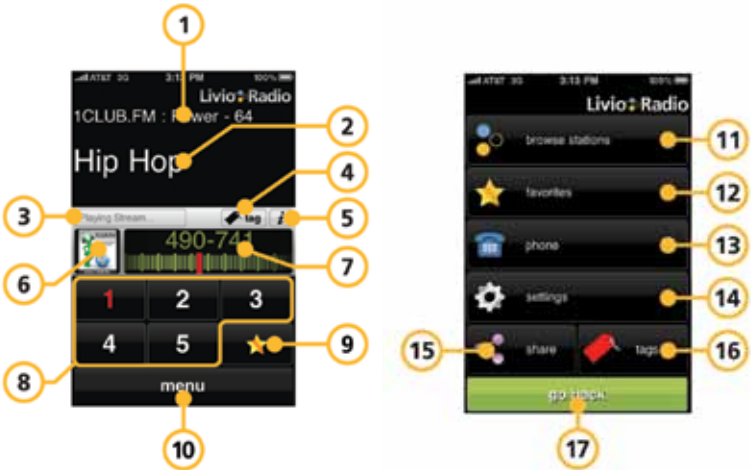

USING THE LIVIO CAR INTERNET RADIO APP

1. **Station Information**
2. **Artist and Title Information:** Touch this area of the screen to stop and restart the audio.
3. **Player Status**
4. **Tag:** Save song information and purchase on iTunes or e-mail the list through the menu.
5. **"i" (Information):** Touch to get more information about the station including multiple streams.
6. **Station ID Logo:** Touch to refresh the stream if you experience skipping audio or stream problems.
7. **Direct Tune and Scan:**
 - a. Tap to bring up the direct tune information. You can enter any direct tune number for a station to quickly access stations.
 - b. Swipe your finger from left to right to activate the scan command to find a station similar to the one currently selected.
8. **Presets:** Tap 1 - 5 to bring up your top 5 favorite stations. Touch and hold one of the Preset buttons (1-5) to store the currently playing station as a Preset.
9. **Star Button:** Tap to bring up your entire Favorites list. Touch and hold to add a station to your Favorites list.
10. **Menu Button:** Tap to bring up a list of the menus and features

available.

11. **Browse Stations:** Tap to search for an Internet radio station. The RadioTime directory has access to local radio stations using GPS, music, talk and sports. You can also search for stations by location, language and Podcasts.
12. **Favorites:** Tap to bring up a list of all of your favorite stations. Here you can rearrange the station order as well as add or delete stations.
13. **Phone:** Available only on mobile phones. This will not work on non-phone devices.
14. **Settings:** Tap to adjust the settings of the app to fit your personal style.
15. **Share:** Tap to share stations via your favorite social media sites or to stream the station in the background through Safari.
16. **Tags:** Tap to bring up a list of all of the songs you have tagged. From this menu you can buy your tagged songs from the iTunes store or email the list to a friend.
17. **Go Back:** Return to the previous screen.

SETTING OPTIONS

1. Go to the settings application on your device. 
2. Select "Livio Radio"
 - a. **Reliability Filter**
 - i. **ON:** Will select stations that have good streaming servers.
 - ii. **OFF:** Will show all stations available.
 - b. **Maximum Bitrate Filter**
 - i. **ON:** Will limit the maximum amount of data per stream that is tuned into when searching for stations.
 - ii. **OFF:** Will show all bitrate feeds.
 - c. **Replay Last Station:** Auto start the last station you were



listening to on app launch.

- d. **Disable Screen Sleep:** Prevents your device from turning off the screen while the app is running.
- e. **Buffer Time** – Increase the buffer time if you are having problems with the audio stream.
- f. **Voice Over** (For compatible products): Allows for easier navigation of the app if you are using the Voice Over accessibility mode option. Turning this setting on lowers the volume of the audio stream when accessing buttons.
- g. **RadioTime Login:** Use this to access your stored favorites if you have a RadioTime account at www.radiotime.com.

All features printed are subject to change.

Data Plan and Charges

This app uses data through your mobile provider. Though the app is set to stop when you are not using it in the vehicle, please always check to make sure that the app is not accidentally left on, as it may continue to use data.

Depending on the station stream bitrate (quality), you may use up to 1GB of data per month if you are a heavy commuter. It is possible to use less or more based on the stations you listen to and the stream quality. Generally audio streaming applications aren't a major concern for data use (compared to video programs), however Livio Radio is not responsible for any overages of data usage or roaming data charges. Please check with your mobile carrier.

Mobile Internet Connection

If you have poor data coverage while driving, we recommend adjusting the bitrate filter in the settings or selecting stations with lower bitrate streams.

Worst case, if you do not have any data coverage you can use the built in MP3 player on your phone through the Kit.

PHONE OPERATIONS

After pairing your phone with the Kit, you can make and receive hands-free calls using buttons featured on the Kit to control the call.

1. **Voice Dial (or accept 2nd line):** Press the *GREEN* call button.
2. **Re-dial:** Double press the *GREEN* call button.
3. **Reject Incoming Call (or reject 2nd line):** Press the *RED* end-call button.
4. **End Call:** Press the *RED* end-call button.

BLUETOOTH OPERATIONS

1. If multiple Bluetooth hands-free devices are connected, call audio will be routed through the device from which the call was initiated/answered.
2. When music resumes after the call ends, it may play through the device that was used for the call.
 - a. In some cases the music may go to another device (based on the other Bluetooth device settings you may be using).
3. If your vehicle is already equipped with hands-free calling, the Kit can still control the Livio app.
4. If audio is no longer playing through the Kit and is playing through the speaker on the Apple product (or some other Bluetooth audio speaker device), here's how to change the Bluetooth settings within the app:
 - a. Go to the Livio app and select: **menu > settings**.
 - b. Tap the icon to the right of the volume bar. It is a small rectangle with a triangle through the bottom, visible only when an A2DP accessory is connected.
 - c. Select **livio_ivc02a**. Audio will now be routed through the Kit.

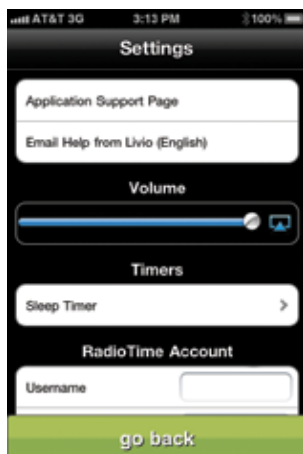

FREQUENTLY ASKED QUESTIONS

What is the red phone indicator light?

When Solid: The red indicator light confirms that your phone is connected to the Kit so you can make hands-free calls.

When Blinking (along with the green indicator light): The Kit is in pairing mode.

When Off: A device is not connected to the Kit.

What is the green phone indicator light?

When Solid: The green indicator light confirms that your phone is connected to the Kit to play music (A2DP streaming).

When Blinking (along with the red indicator light): The Kit is in pairing mode.

When Blinking (red indicator light is off): The Kit is paired to a device but not connected. The Kit may also be put into pairing mode while the green indicator light is blinking (see Quick Start Guide).

How do I improve the sound quality in my car?

Make sure the Kit is showing the same frequency as your car stereo. This should also be an unused (or static) frequency when the Kit is turned off. To find an unused frequency, press and hold the knob on the Kit for approximately 3 seconds.

In cars where the FM antenna is located on the roof or back glass, it may be necessary to connect with the AUX input cable to your stereo. Unfortunately, the FCC limits the amount of power and distance that is allowed for transmission over FM.

Why is my phone not connecting to the Kit through Bluetooth?

First, when the phone is paired, you will hear a beep sound when the Kit is turned on (assuming you have your FM radio tuned in).

When the phone is paired, you will see the red and green lights come on the Kit's phone buttons. If the red and green lights are not illuminated, press and hold the end call button for approximately 3 seconds and the green and red lights will flash to enter pairing mode.

While the lights are flashing, set up Bluetooth on your phone.

From the home screen on your Apple product, select:

Settings -> General -> Bluetooth -> livio_lvc02a.

Music is not playing through my car speakers.

Make sure your phone is connected to the Kit. The green and red lights on the Kit will light up when this is completed.

While your car is running, turn the Kit off with the power switch on the 12V adapter. Then turn the Kit back on.

Did you hear a beep sound?

YES!

If you heard a beep sound, it means your car stereo is correctly connected to the Kit.

To confirm pairing, the green light should be lit on the Kit. If the green light is not lit, your phone is not correctly set up for A2DP music streaming with the Kit. Please call us for advanced help at 1-877-97-LIVIO.

If the green light is on, try using other music applications, as it's possible there may be a data (Internet) problem with your phone connecting to the Internet to play Internet radio. You can test for this problem by playing MP3s on your phone.

If you heard a beep sound and still do not hear music, then the problem is with the music app on your phone.

Try:

Refreshing the current station by pressing the station art.

Listening to a different station.

Restarting the app and/or the Kit.

NO!

If you did not hear a beep sound, it means that your car stereo is not correctly connected to the Kit. Check to ensure:

The FM frequency on the car stereo matches the frequency on the Kit's display.

The volume of your stereo is not set to zero.

The Kit's volume is not set to zero (press the knob on the Kit to switch from FM frequency to volume control).

Why are the controls not working on my attached MP3 player?

The Kit can only control applications on your phone that support "AVRCP" remote controls (this includes most applications).

Because there are thousands of applications available, we can only fully support the Livio Car Internet Radio app. We do, however, try to work with as many other apps as possible.

How far does the Kit work from my phone and FM stereo wirelessly?

The maximum Bluetooth transmission distance from the Kit to your phone is about 10 meters. So, as long as you're not in a limo, you should be good.

The FM transmitter range from the Kit to your FM antenna is, at most, 4 meters (note: this is the distance from the Kit to your antenna, not your FM stereo). The FCC requires this limitation and, unfortunately, we can't increase it.

Do I need to download the Livio Car Internet Radio app?

Yes. However, Apple product users should receive a prompt indicating that the free app needs to be installed once your are paired with the kit.

Do all premium features unlock with the Livio Car Internet Radio app?

At the time this user guide was printed, the only premium feature that is unlocked with the Kit is the station listing of the more than 45,000 AM/FM and Internet-only stations. When your device is not connected to the Kit, this feature becomes locked unless a station is saved to one of your Presets stations. If you want to permanently unlock this feature while using the app, you will need to pay for the upgrade.

What if I already own a Bluetooth headset or my car is equipped with Bluetooth calling? May I still use the Kit?

Yes. You may use your current hands-free device to make and receive calls while using the Kit remote functions to control the Livio app. Use your Bluetooth headset (or car) Bluetooth calling feature as you normally would. Use the Kit to send audio through the FM transmitter or the Aux input on your car radio.

Pairing: I am pressing the red button but the Kit is not flashing to enter pairing mode.

If the red and green call buttons are illuminated, it means that the Kit is already connected to a Bluetooth device. Turn off the connected Bluetooth device and the red and green buttons will turn off (with the green button flashing). Then press and hold the end call button to enter pairing mode.

Need Additional Help?

Call 1-877-97-LIVIO or check out www.livioradio.com/help for online videos and more info.

SPECIFICATIONS

Bluetooth version

Bluetooth v2.1

Bluetooth profiles

HSP, HFP, A2DP and AVRCP

Frequency response

2.4GHz-2.4835GHz

FM frequency

88.1-107.9MHz (US mode)

87.9-107.9 (EU mode)

Bluetooth range

10M

FM range

4M

Input

DC 12V-24V

USB output

DC 5.0V

1000mA

Dimension

91x48x28 mm

Weight



Main body: 46.1 g

12V adapter with gooseneck: 81.5 g

Fuse

2A, 250V

IMPORTANT SAFETY INSTRUCTIONS

 <p>The lightning flash with arrowhead symbol, within an equilateral triangle is intended to alert the user to the presence of insulated 'dangerous voltage' within the product's enclosure that may be of sufficient magnitude to constitute a risk of electric shock to persons.</p>	<table border="1"> <tr> <td style="text-align: center;">CAUTION</td> </tr> <tr> <td style="text-align: center;">RISK OF ELECTRIC SHOCK DO NOT OPEN</td> </tr> </table> <p>WARNING: To reduce the risk of electric shock, do not remove cover (or back). No user serviceable parts are inside. Refer servicing to qualified personnel.</p>	CAUTION	RISK OF ELECTRIC SHOCK DO NOT OPEN	 <p>The exclamation point within an equilateral triangle is intended to alert the user to the presence of important operating and maintenance (servicing) instructions in the literature accompanying the appliance.</p>
CAUTION				
RISK OF ELECTRIC SHOCK DO NOT OPEN				

1. Read these instructions.
2. Keep these instructions.
3. Heed all warnings.
4. Follow all instructions.
5. Do not use this apparatus near water.
6. Clean only with dry cloth.
7. Use in accordance with the manufacturer's instructions.
8. Use replacement parts as specified by the manufacturer.

WARRANTY

Livio Radio
3136 Hilton Rd.
Ferndale, MI 48220
(248) 591-0333
1 (877) 97-LIVIO

help@livioradio.com

www.livioradio.com/help

Livio Radio ("Livio") Limited Consumer Warranty - United States of America

Livio Radio warrants all Radio Products sold by Livio (each "Product") to be free of defects in material and workmanship, subject to the following conditions:

The duration of Livio Radio's warranty with respect to each Product is limited to one (1) year from the date of sale to the original consumer purchaser. No other express warranties are made with respect to any Product.

All implied warranties, including warranties of merchantability and fitness for a particular product are limited to the warranty period set forth above. This warranty is not transferable and applies only to the original consumer purchaser of the Product. Livio Radio will, as its sole obligation under

this warranty, replace or repair, at its option, any Product that does not conform to this warranty. Products may be repaired or replaced with new or refurbished items. This limited warranty does not cover defects in appearance, cosmetic or decorative items, including any non-operative parts. Under no circumstances will Livio Radio be liable for any incidental or consequential damages under this warranty or any implied warranties. These remedies are the customer's exclusive remedies for breach of warranty. This limited warranty only extends to customers who purchase the Products in the United States.

FCC Compliance and Advisory Statement:

This device complies with part 15 of the FCC rules. Operation is subject to the following two conditions:

1. This device may not cause harmful interference, and
2. This device must accept any interference received, including interference that may cause undesired operation.

This Class B digital apparatus complies with Canadian ICES-003.

Cette appareil numérique de la classe B conforme aux NMB-003 du Canada.

Livio Radio will not be responsible for damage resulting from any Installation of a Product in a manner, which is inconsistent with Livio Radio's instructions.

1. Alteration or modification of a Product
2. Misuse
3. Neglect
4. Abuse
5. Accident
6. Scratches, dents, or other cosmetic defects not a result of manufacturer's defect
7. Commercial use
8. Improper storage
9. Environmental conditions, including excessive temperature or humidity
10. Service by any entity other than a Livio Radio authorized repair facility
11. Use of the Product in conjunction with any non-Livio Radio branded accessory
12. Other improper application, installation or operation of this Product, or
13. Defects or malfunctions of which Livio Radio is not advised within ten (10) days of the expiration of the limited warranty period.

How You Can Get Service

To obtain warranty service during the first thirty (30) days after the date of purchase, you must return the defective Product with the original receipt to the original place of purchase. To obtain warranty service during the first thirty (30) days for Products purchased specifically from www.LivioRadio.com you must contact the E-Store directly at the number provided on your invoice. For all Products for the remainder of the limited warranty period, you must contact Livio Radio by phone at the customer service number listed at www.LivioRadio.com. If further clarification or additional information is required from Livio Radio, you may call Livio Radio at our customer service number listed at www.LivioRadio.com. If warranty service is needed at any time during the warranty period, the purchaser will be required to furnish a sales receipt/proof of purchase indicating the date of purchase, amount paid and place of purchase. Customers who fail to provide such proof of purchase will have the Product returned to them or will be charged for the repair/replacement of any Product. The customer is responsible for shipping the Product to an authorized Livio Radio Warranty Facility.

How State Law Relates to the Warranty

Some states do not allow limitations on the duration of implied warranties, or the exclusion or the limitation of incidental or consequential damages. Thus, the above limitations or exclusions may not apply to you. This warranty gives you specific legal rights. You may also have other rights that may vary from state to state. NO PERSON IS AUTHORIZED BY LIVIO RADIO TO MODIFY OR ADD TO THIS LIMITED WARRANTY.

Canada Warranty

Livio Radio warrants all Radio Products sold by Livio Radio (each "Product") to be free of defects in material and workmanship, subject to the following conditions:

The duration of Livio Radio's warranty with respect to each Product is limited to one (1) year from the date of sale to the original consumer purchaser. No other express warranties are made with respect to any Product.

All implied warranties, including warranties of merchantability and fitness for a particular product are limited to the warranty period set forth above. This warranty is not transferable and applies only to the original consumer purchaser of the Product. Livio Radio will, as its sole obligation under this warranty, replace or repair, at its option, any Product that does not conform to this warranty.

This limited warranty does not cover defects in appearance, cosmetic or decorative items, including any non-operative parts. Under no circumstances will Livio Radio be liable for any loss of revenue, loss of profits or failure to realize expected savings (collectively, "Economic Loss") under this warranty or any implied conditions or warranties. These remedies are the customer's exclusive remedies for breach of conditions or warranty. This limited warranty only extends to customers who purchase the Products in Canada.

Livio Radio will not be responsible for damage resulting from any

1. Deviation from Livio Radio's operating instructions as printed in Livio Radio's catalog or on any packaging, labels or other literature provided with a Product
2. Installation of a Product in a manner, which is inconsistent with Livio Radio's written instructions
3. Alteration or modification of a Product
4. Misuse
5. Use on a foosball table
6. Neglect
7. Abuse
8. Accident
9. Normal wear and tear
10. Commercial use
11. Improper storage
12. Environmental conditions, including excessive temperature or humidity
13. Service by any entity other than a Livio Radio authorized repair facility
14. Use of the Product in conjunction with any non-Livio Radio branded accessory
15. Other improper application, installation or operation of this Product, or
16. Defects or malfunctions of which Livio Radio is not advised within ten (10) days of the expiration of the limited warranty period.

How You Can Get Service

To obtain warranty service during the first thirty (30) days after the date of purchase, you must return the defective Product with the original receipt to the original place of purchase. To obtain



warranty service during the first thirty (30) days for Products purchased specifically from www.LivioRadio.com you must contact the E-Store directly at the number provided on your invoice. For all Products for the remainder of the limited warranty period, you must contact Livio Radio by phone at the customer service number listed at www.LivioRadio.com. If further clarification or additional information is required from Livio Radio, you may call Livio Radio at our customer service number listed at www.LivioRadio.com. If warranty service is needed at any time during the warranty period, the purchaser will be required to furnish a sales receipt/proof of purchase indicating the date of purchase, amount paid and place of purchase. Customers who fail to provide such proof of purchase will have the Product returned to them or will be charged for the repair/replacement of any Product. The customer is responsible for shipping the Product to an authorized Livio Radio Warranty Facility.

How Provincial Law Relates to the Warranty

Some provinces do not allow limitations on the duration of implied conditions or warranties, or the exclusion or the limitation of Economic Loss. Thus, the above limitations or exclusions may not apply to you. This warranty gives you specific legal rights. You may also have other rights that may vary from province to province.

NO PERSON IS AUTHORIZED BY LIVIO RADIO TO MODIFY OR ADD TO THIS LIMITED WARRANTY

